

1/4" TUBE MODBUS MFM STD SIZE VERSION

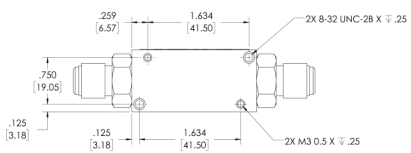
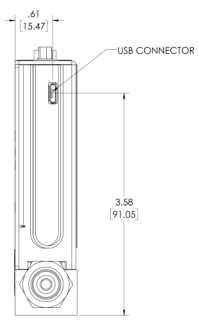
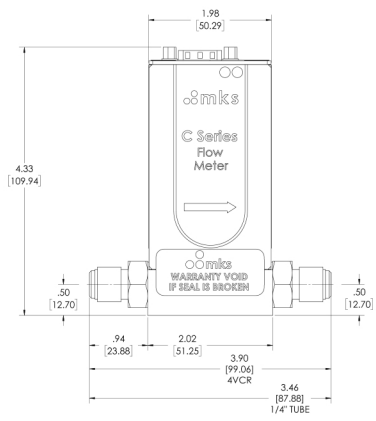
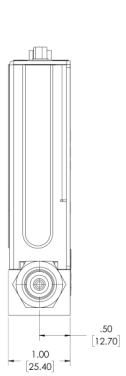
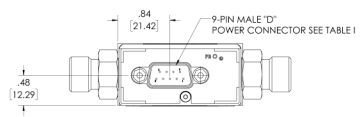

C-SERIES MFM RS485/ANALOG VERSION WITH 4VCR FITTINGS

TABLE 1	
* PIN 1	VALVE CLOSED SIGNAL
PIN 2	FLOW OUTPUT
PIN 3	+24 POWER INPUT
PIN 4	POWER COMMON
PIN 5	RS485 (-)
* PIN 6	ANALOG SET POINT
PIN 7	RS485 (+) SIGNAL COMMON
PIN 8	AL+ (RS485+)
* PIN 9	VALVE OPEN SIGNAL
* NOT APPLICABLE FOR MFM	
 PIN 4 & 7 TIED INTERNALLY	

Dimensional Drawing - Standard Length (top); Reduced Length (bottom)
 Note: Unless otherwise specified, dimensions are nominal values in inches (mm referenced).